

CLEARING AND GRUBBING
EROSION CONTROL FOR
CONSTRUCTION SHEET 13

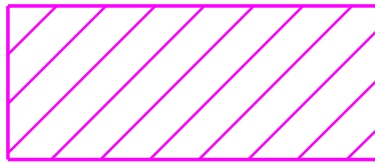

ENVIRONMENTALLY SENSITIVE AREA
SEE PROJECT SPECIAL PROVISIONS

NOTE: PLACE TEMPORARY ROCK SEDIMENT DAMS
TYPE-B AND TEMPORARY ROCK SILT CHECKS
TYPE-A AT DRAINAGE OUTLETS.

NOTE: FLOATING TURBIDITY CURTAIN MAY BE
USED IN PLACE OF IMPERVIOUS DIKE WHERE
WORK PERMITS.

DF18314
2045067

EC-13 CONST. 13

NORTH CAROLINA
DEPARTMENT OF TRANSPORTATION
HENDERSON COUNTY

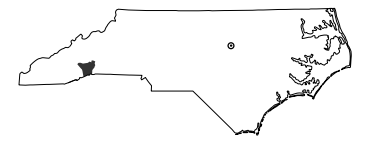

HIGHWAY DIVISION 14

PREPARED BY



NC FIRM LICENSE No: C-1506
301 Fayetteville St.,
Suite 1500
Raleigh, NC 27601
(919)882-7839

-L10-

CUR DATA -L10-
P/c 10+53.89
 $\Delta c = 31^{\circ}49'53.2''$ (LT)
D = $30^{\circ}18'54.8''$
Lc = 105.00
Tc = 53.89
R = 189
SE = EXIST.
RO = N/A

CUR DATA -L10-
P/c 11+97.21
 $\Delta c = 28^{\circ}05'27.5''$ (RT)
D = $26^{\circ}46'25.4''$
Lc = 104.92
Tc = 53.54
R = 214
SE = EXIST.
RO = N/A

BEGIN CONSTRUCTION
DF18314.2045067
-L10- STA 11+10.00

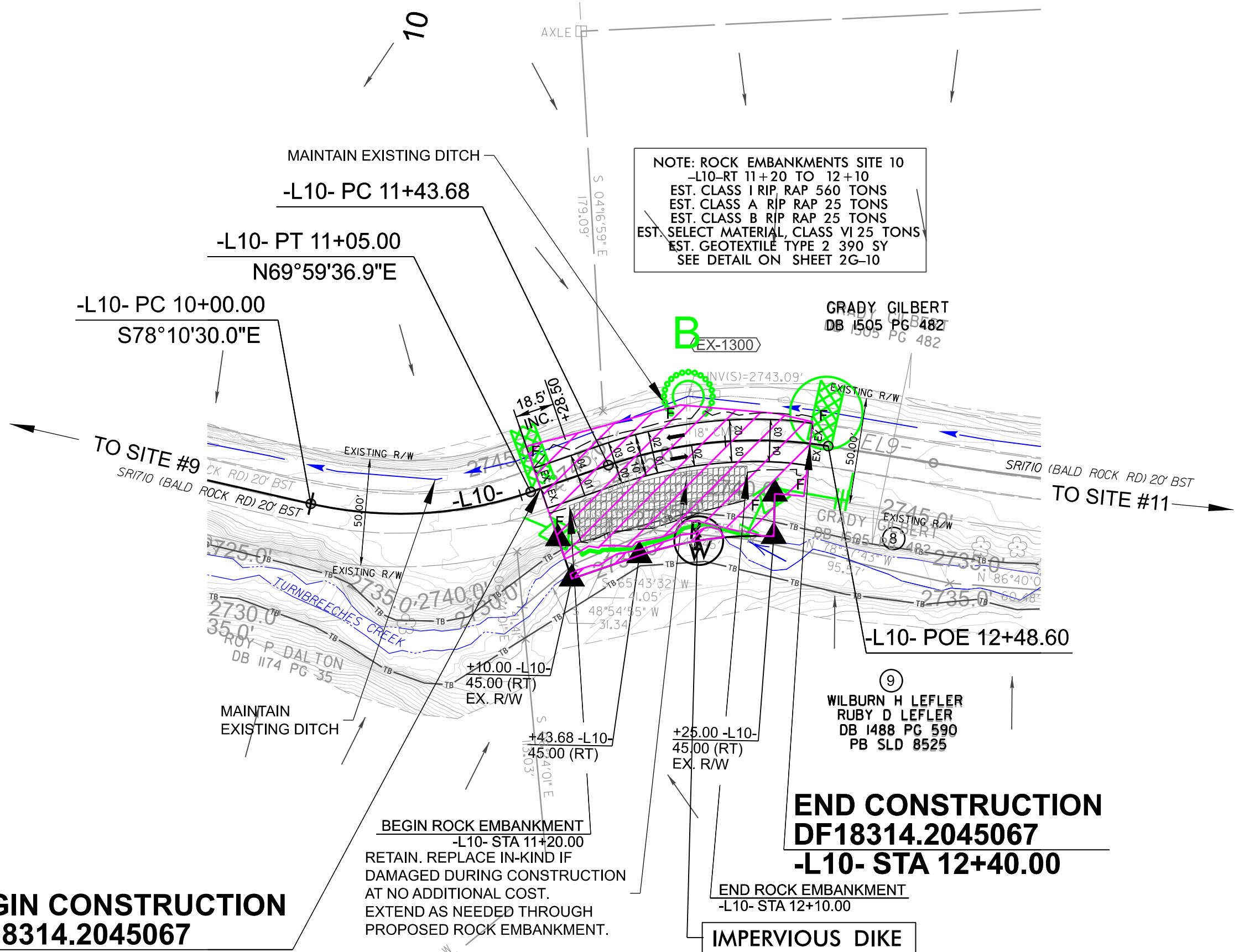

END CONSTRUCTION
DF18314.2045067
-L10- STA 12+40.00

NOTES:
SEE SHEET NO. 2G-10 FOR GEOTECH DETAILS.

BALD ROCK ROAD (SR1710) SHALL BE RECONSTRUCTED UTILIZING THE EXISTING
SECONDARY ROAD AGREEMENTS ALREADY IN PLACE EXCEPT WHERE PROPOSED
RIGHT OF WAY AND EASEMENTS ARE SHOWN ON THE PLANS.

REVISIONS